

# Cast Iron Knife Gate Valve - Bidirectional - Pneumatic Actuator

LV 9997

Lugged PN10, Cast Iron Powder Coated Body, 304 Stainless Steel Gate, EPDM Seat & O-ring, Bidirectional, Double Acting Actuator, with Protection Plates



Pressure / Temperature Specifications	
Pressure	PN10
Temperature	-20°C to 110°C

Material Specifications	
1. Body	GG25 Cast Iron
2. Valve Cap	GG25 Cast Iron
3. Nut	Stainless Steel
4. Washer	Stainless Steel
5. Stud A Bolt	Stainless Steel
6. Gate	304 Stainless Steel
7. Plate Stay	Q235 Steel
8. Safety Guards	304 Stainless Steel
9. Screw	304 Stainless Steel
10. O-ring	NBR
11. Seat	EPDM
12. Gland	PTFE
13. Position Indicator	304 Stainless Steel
14. Bolt	304 Stainless Steel
15. Polyamide Nut	304 Stainless Steel
16. Piston Stem	304 Stainless Steel
17. Cylinder Cover	Aluminium
18. Bolt	304 Stainless Steel
19. Spring Washer	304 Stainless Steel
20. Dust Proof Sealing	NBR
21. Oil Bearing	Composite
22. Stem Gasket	NBR
23. Piston	Aluminium
24. Socket Bolt & Spring Washer	Stainless Steel
25. Cylinder Shell	Aluminium
26. Sealing Ring	NBR
27. Cushion Seal	NBR
28. Cylinder Cover	Aluminium

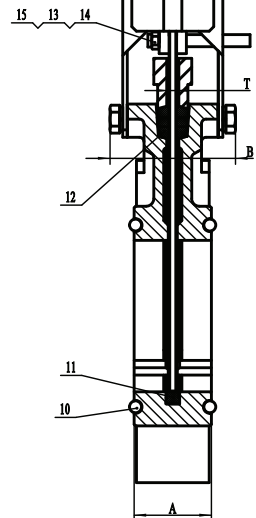
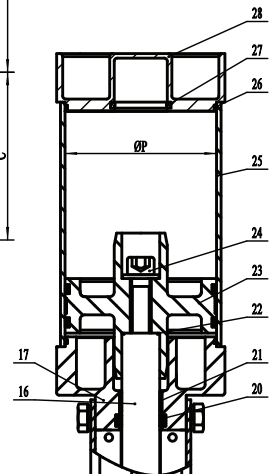
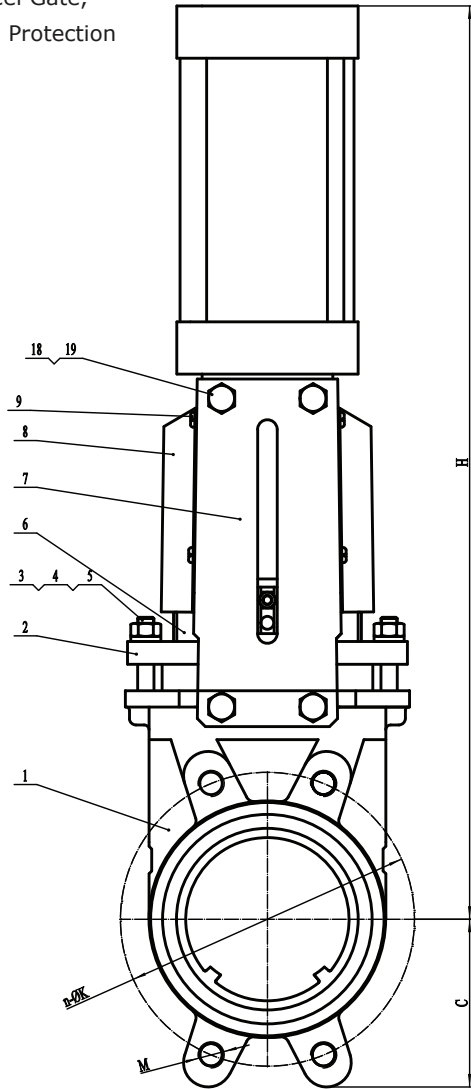

Dimensions										
DN	A	B	C	H	P	K	T	n	M	Kg
2"	40	85	60	417	100	125	5	4	M16	9.2
2½"	40	85	65	457	100	145	5	4	M16	9.7
3"	50	85	95	490	100	160	5	8	M16	11.5
4"	50	85	105	560	100	180	5	8	M16	13.3
5"	50	96	118	655	125	210	6	8	M16	19.5
6"	60	96	132	734	125	240	6	8	M20	22.2
8"	60	113	158	920	160	295	8	8	M20	49.0
10"	70	113	196	1085	200	350	8	12	M20	71.0
12"	80	113	220	1238	200	400	10	12	M20	87.5