

# Stainless Steel Ball Valve - Flanged ANSI 150 - ISO Top



LV 6373

ISO 5211 for Direct Mount, Flanged ANSI 150, Full Bore, CF8M  
 Stainless Steel Body, Ball & Stem, TFM 1600 Seats & Seals,  
 Anti-blowout Stem, Anti-static Device, Firesafe Design, ATEX Approved



Pressure / Temperature Specifications	
Pressure	CL150
Temperature	-10°C to 180°C

Material Specifications	
1. Body	CF8M Stainless Steel
2. End Cap	CF8M Stainless Steel
3. Ball	CF8M Stainless Steel
4. Stem	316 Stainless Steel
5. Seat	TFM 1600
6. Body Seal	Graphite
7. Thrust Washer	TFM 1600
8. Stem Seal	Graphite
9. O-Ring	Viton
10. Gland Ring	304 Stainless Steel
11. Disc Spring	301 Stainless Steel
12. Stem Nut	304 Stainless Steel
13. Lock Washer	304 Stainless Steel
14. Body Bolt	304 Stainless Steel
15. Body Nut	304 Stainless Steel
16. Body Bolt	304 Stainless Steel
17. Body Nut	304 Stainless Steel
18. Handle	304 Stainless Steel
19. Adapter	CF8 Stainless Steel
20. Handle	304 Stainless Steel
21. Handle Nut	304 Stainless Steel
22. Sleeve	Plastic
23. Set Screw	304 Stainless Steel
24. Stop Pin	304 Stainless Steel
25. Stopper	304 Stainless Steel
26. Nut	304 Stainless Steel

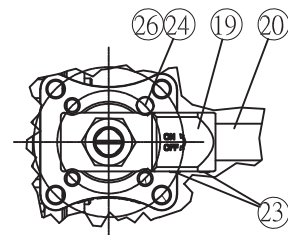
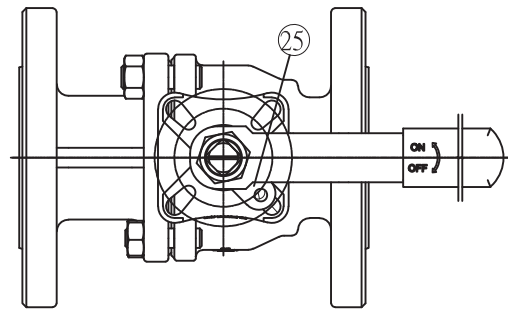
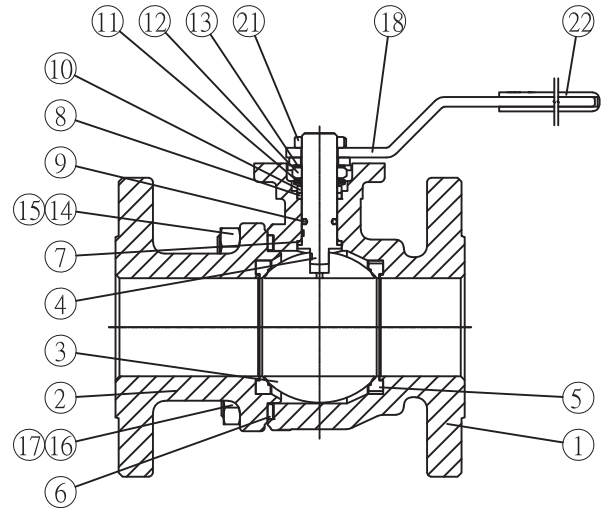

2-1/2"~6"

Torque Figures	
Size	Nm
1/2"	7.5
3/4"	12.5
1"	16.0
1 1/2"	31.0
2"	38.0
3"	88.0
4"	125.0
6"	250.0
8"	600.0

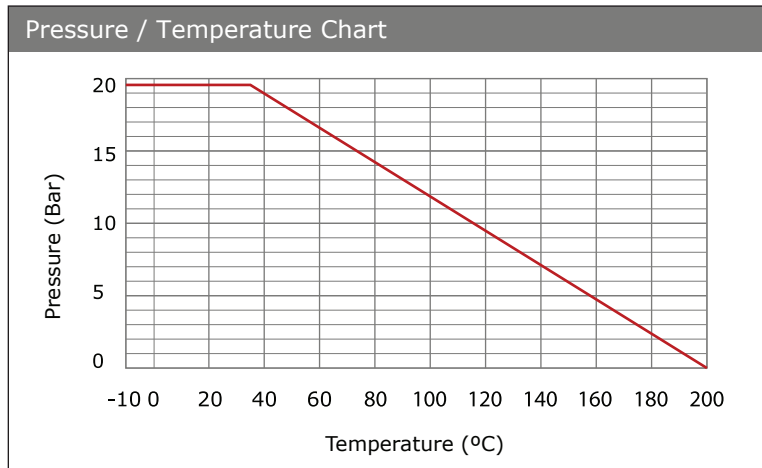

Continues on Page 2

# Stainless Steel Ball Valve - Flanged ANSI 150 - ISO Top



LV 6373

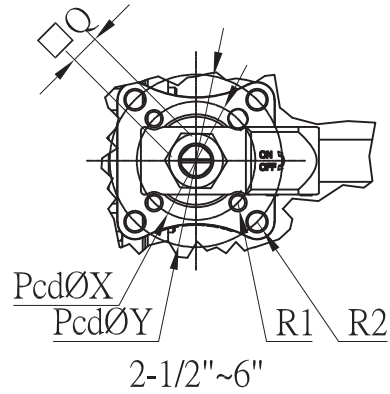
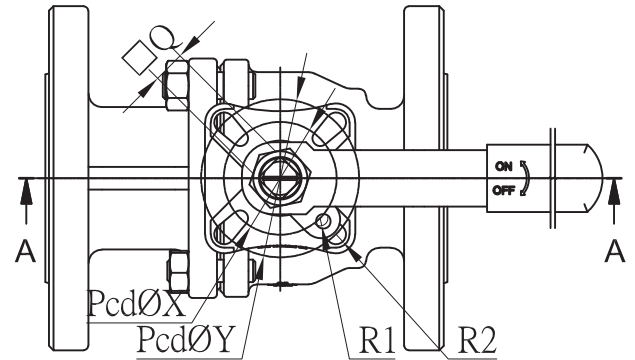
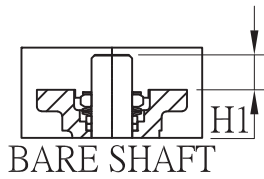
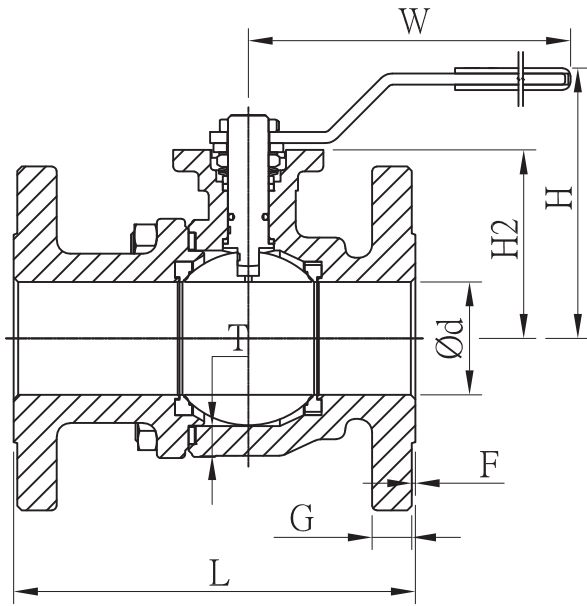

Dimensions												
Size	Ød	ØC	ØE	F	G	I x ØH	L	W	H	H2	T	Kg
1/2"	15	60.5	89	1.6	9.6	4 x 16	108	165	90	46.5	3.1	2.2
3/4"	20	70	98	1.6	11.2	4 x 16	117	165	96	51.5	3.7	2.6
1"	25	79.5	108	1.6	12.7	4 x 16	127	165	97	57.5	3.9	3.65
1 1/2"	40	98.5	127	1.6	15.9	4 x 16	165	205	111	76.5	4.9	6.85
2"	50	120.5	152.4	1.6	17.5	4 x 19	178	205	118	83.5	5.5	9.65
3"	80	152.5	190.5	1.6	22.3	4 x 19	203	280	163	129.5	6.1	19.6
4"	100	190.5	229	1.6	22.3	8 x 19	229	380	178	145.0	6.5	27.3
6"	150	241.3	280	1.6	23.9	8 x 22.5	394	610	219	175.0	7.1	53.0

Dimensions						
Size	ØX	ØY	R1	R2	Q	H1
1/2"	42	-	Ø6	-	9	10.5
3/4"	42	50	R3.0	R3.5	9	9.5
1"	42	50	R3.0	R3.5	11	10.5
1 1/2"	50	70	R3.5	R4.5	14	15.5
2"	50	70	R3.5	R4.5	14	15.5
3"	70	102	M10	Ø11	17	18.5
4"	70	102	M10	Ø11	17	18.5
6"	102	125	R6.0	R7.0	27	30.0

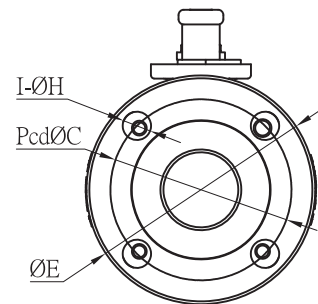

Continues on Page 2

# Stainless Steel Ball Valve - Flanged ANSI 150 - ISO Top



LV 6373

## Material Specifications (8")

1. Body	CF8M Stainless Steel
2. End Cap	CF8M Stainless Steel
3. Ball	CF8M Stainless Steel
4. Seat	TFM 1600
5. Stem	304 Stainless Steel
6. Gasket	TFM 1600
7. Thrust Washer	TFM 1600
8. O-ring	Viton
9. Packing	TFM 1600
10. Gland	304 Stainless Steel
11. Stem Nut	304 Stainless Steel
12. Stop Washer	304 Stainless Steel
13. Handle Washer	304 Stainless Steel
14. Handle	304 Stainless Steel
15. Stop Pin	304 Stainless Steel
16. Bolt	304 Stainless Steel
17. Handle Cover	Plastic
18. Tuning Screw	304 Stainless Steel
19. Support Nut	304 Stainless Steel
20. Support Pin	316 Stainless Steel
21. Pin Packing	Graphite
22. Pin Seat	PTFE

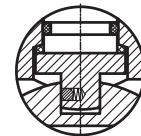
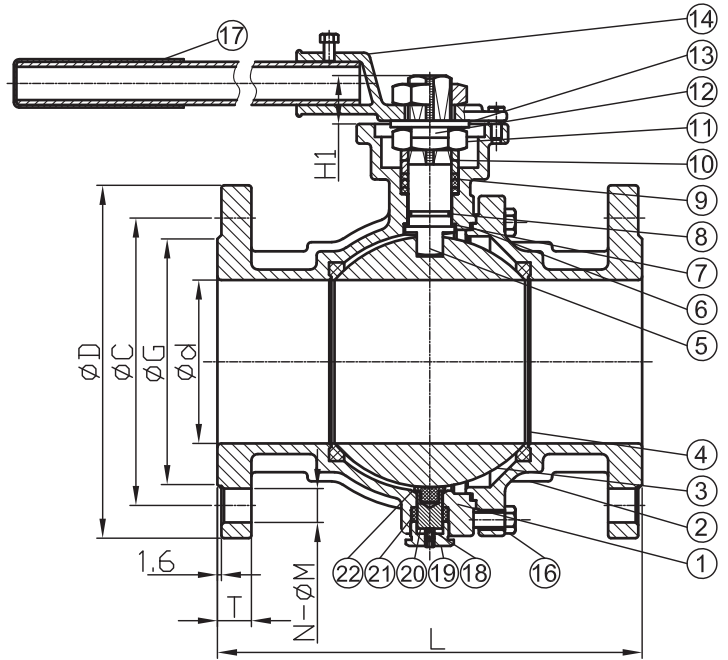

Anti-static device

## Dimensions (8")

Size	Ød	ØD	ØC	ØG	T	N-ØM	L	H	Kg
8"	200	343	298.5	270	28.6	8 x 22	457	304	97.5

## Dimensions (8")

Size	H1	W	W1	ISO	E	ØR
8"	36	920	36	F14	140	18

