

Stainless Steel Ball Valve - Flanged PN16 - ISO Top



LV 6353

ISO 5211 for Direct Mount, Flanged PN16, Full Bore, CF8M Stainless Steel Body, Ball & Stem, TFM 1600 Seats & Seals, Anti-blowout Stem, Anti-static Device, Firesafe Certified, ATEX Approved



Pressure / Temperature Specifications	
Pressure	PN40 1/2" to 2"
	PN16 2 1/2" to 8"
Temperature	-10°C to 180°C

Material Specifications (1/2" to 6")	
1. Body	1.4408 Stainless Steel
2. End Cap	1.4408 Stainless Steel
3. Ball	CF8M Stainless Steel
4. Stem	316 Stainless Steel
5. Seat	TFM 1600
6. Body Seal	Graphite
7. Thrust Washer	TFM 1600
8. Stem Seal	Graphite
9. O-Ring	Viton
10. Gland Ring	304 Stainless Steel
11. Disc Spring	301 Stainless Steel
12. Stem Nut	304 Stainless Steel
13. Lock Washer	304 Stainless Steel
14. Body Bolt	304 Stainless Steel
15. Body Nut	304 Stainless Steel
16. Body Bolt	304 Stainless Steel
17. Body Nut	304 Stainless Steel
18. Handle	304 Stainless Steel
19. Adapter	CF8 Stainless Steel
20. Handle	304 Stainless Steel
21. Handle Nut	304 Stainless Steel
22. Sleeve	Plastic
23. Set Screw	304 Stainless Steel
24. Stop Pin	304 Stainless Steel
25. Stopper	304 Stainless Steel
26. Nut	304 Stainless Steel

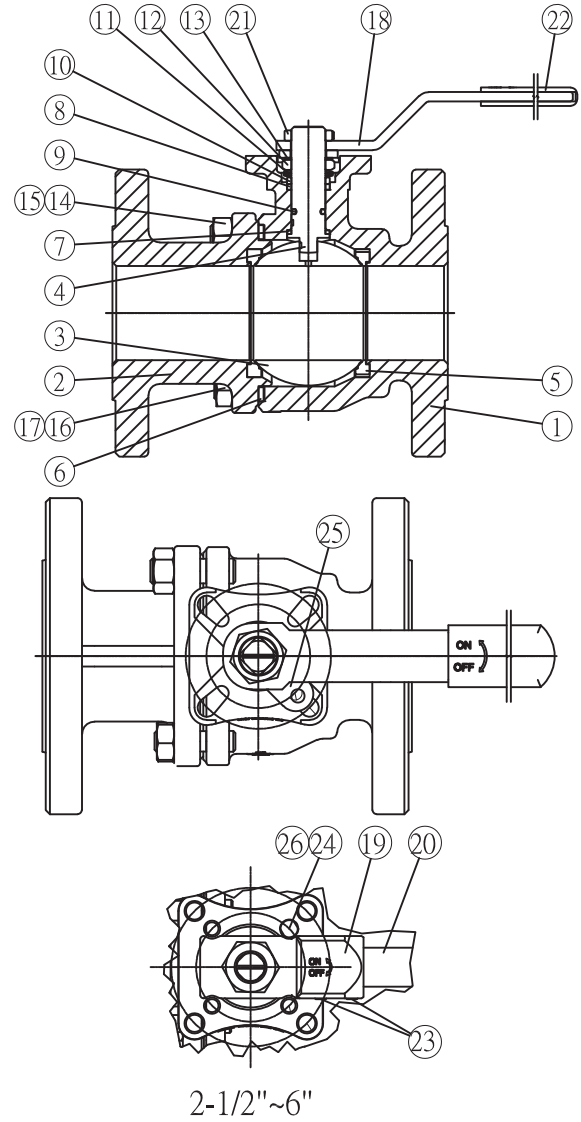

Torque Figures	
Size	Nm
1/2"	7.5
3/4"	12.5
1"	16.0
1 1/4"	23.0
1 1/2"	31.0
2"	38.0
2 1/2"	56.0
3"	88.0
4"	125.0
5"	188.0
6"	250.0
8"	600.0

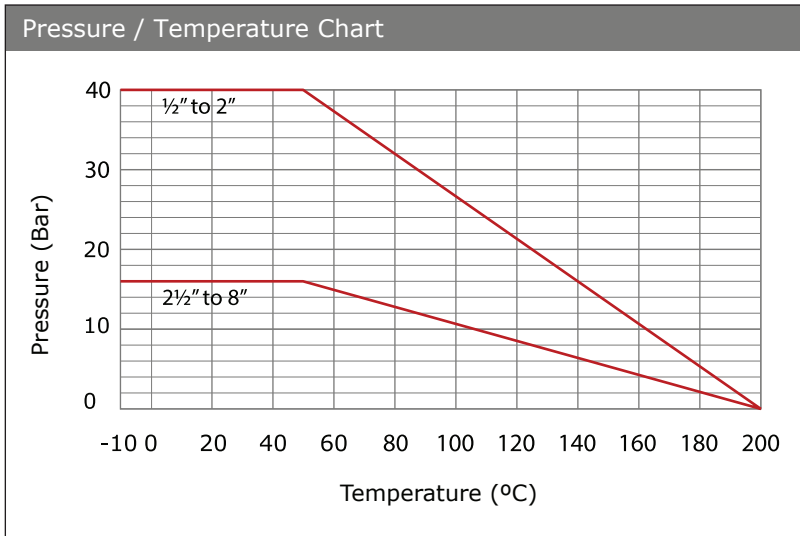

Continues on Page 2

Stainless Steel Ball Valve - Flanged PN16



LV 6353

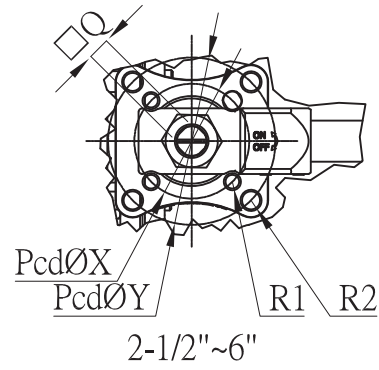
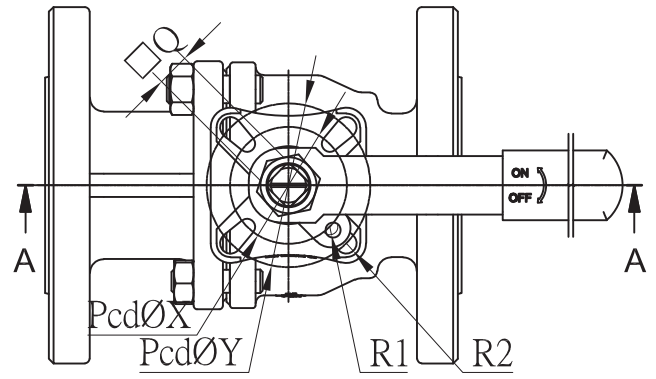
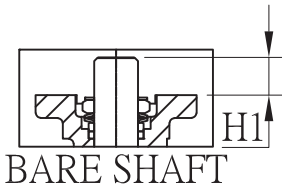
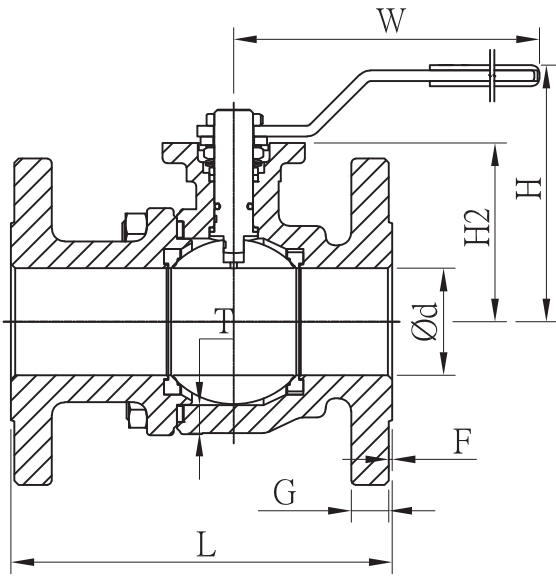

Dimensions (1/2" to 6")												
Size	Ød	ØC	ØE	F	G	I x ØH	L	W	H	H2	T	Kg
1/2"	15	65	95	2.0	14	4 x 14	115	165	93	49.5	3.1	2.2
3/4"	20	75	105	2.0	16	4 x 14	120	165	97	53.1	5.0	2.6
1"	25	85	115	2.0	16	4 x 14	125	165	98	57.5	6.0	3.65
1 1/4"	32	100	140	2.0	16	4 x 18	130	205	106	71.5	6.0	6.15
1 1/2"	40	110	150	3.0	15	4 x 18	140	205	111	76.5	6.0	6.85
2"	50	125	165	3.0	17	4 x 18	150	205	118	83.5	6.5	9.65
2 1/2"	65	145	185	3.0	15	4 x 18	170	280	152	118.5	6.5	15.2
3"	80	160	200	3.0	17	8 x 18	180	280	163	129.5	7.0	19.6
4"	100	180	220	3.0	17	8 x 18	190	380	178	145.0	7.0	27.3
5"	125	210	250	3.0	19	8 x 18	325	610	202	158.5	6.8	43.5
6"	150	240	285	3.0	19	8 x 22	350	610	219	175.0	7.1	62.0

Dimensions (1/2" to 6")						
Size	ØX	ØY	R1	R2	Q	H1
1/2"	42	-	Ø6	-	9	7.5
3/4"	42	50	R3.0	R3.5	9	8.0
1"	42	50	R3.0	R3.5	11	10.5
1 1/4"	50	70	R3.5	R4.5	14	15.5
1 1/2"	50	70	R3.5	R4.5	14	15.5
2"	50	70	R3.5	R4.5	14	15.5
2 1/2"	70	102	M10	Ø11	17	18.5
3"	70	102	M10	Ø11	17	18.5
4"	70	102	M10	Ø11	17	18.5
5"	102	125	R6.0	R7.0	27	30.0
6"	102	125	R6.0	R7.0	27	30.0

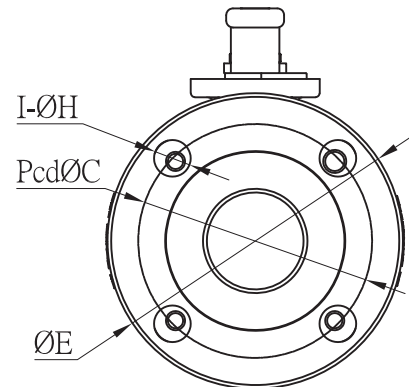

Continues on Page 3

Stainless Steel Ball Valve - Flanged PN16



LV 6353

Material Specifications (8")

1. Body	1.4408 Stainless Steel
2. End Cap	1.4408 Stainless Steel
3. Ball	1.4408 Stainless Steel
4. Seat	PTFE
5. Stem	316 Stainless Steel
6. Gasket	PTFE
7. Thrust Washer	TFM 4215
8. O-ring	Viton
9. Packing	PTFE
10. Gland	304 Stainless Steel
11. Stem Nut	304 Stainless Steel
12. Stop Washer	304 Stainless Steel
13. Handle Washer	304 Stainless Steel
14. Handle	304 Stainless Steel
15. Stop Pin	304 Stainless Steel
16. Bolt	304 Stainless Steel
17. Handle Cover	Plastic
18. Tuning Screw	304 Stainless Steel
19. Support Nut	304 Stainless Steel
20. Support Pin	316 Stainless Steel
21. Pin Packing	Graphite
22. Pin Seat	PTFE

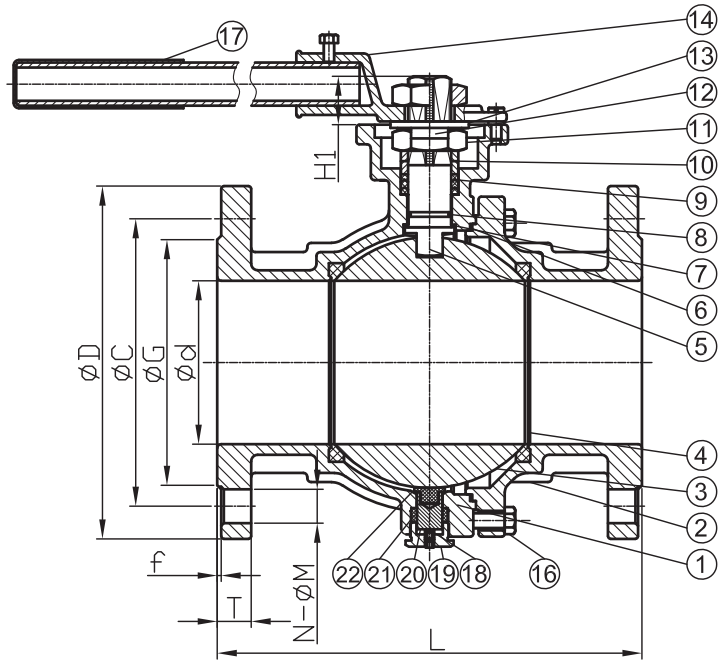

Anti-static device

Dimensions (8")

Size	Ød	ØD	ØC	ØG	f	T	N-ØM	L	H	Kg
8"	200	340	295	268	3	24	12 x 22	400	304	92.0

Dimensions (8")

Size	H1	W	W1	ISO	E	ØR
8"	36	920	36	F14	140	18

