

Brass Ball Valve - ISO Top



LV 4502

Screwed BSPP, ISO 5211 Connection for Direct Mount, Nickel Plated Brass Body, RPTFE Seats



| Pressure / Temperature Specifications | | |
|---------------------------------------|----------------|-----------|
| Pressure | PN40 | ½" to 2" |
| | PN30 | 2½" to 4" |
| Temperature | -20°C to 170°C | |

| Material Specifications | |
|--------------------------------|----------------------------|
| 1. Body | Nickel Plated CW617N Brass |
| 2. Seat | Graphite Filled 15% RPTFE |
| 3. Ball | Chrome Plated CW617N Brass |
| 4. End Cap | Nickel Plated CW617N Brass |
| 5. Washer | Carbon Filled 25% RPTFE |
| 6. Stem with O-ring | Nickel Plated CW617N Brass |
| 7. O-ring | FPM |
| 8. O-ring | FPM |
| 9. Flange (2½" - 4" only) | Black Anodized Aluminium |
| 10. Grub Screw (2½" - 4" only) | CB4FF Steel |

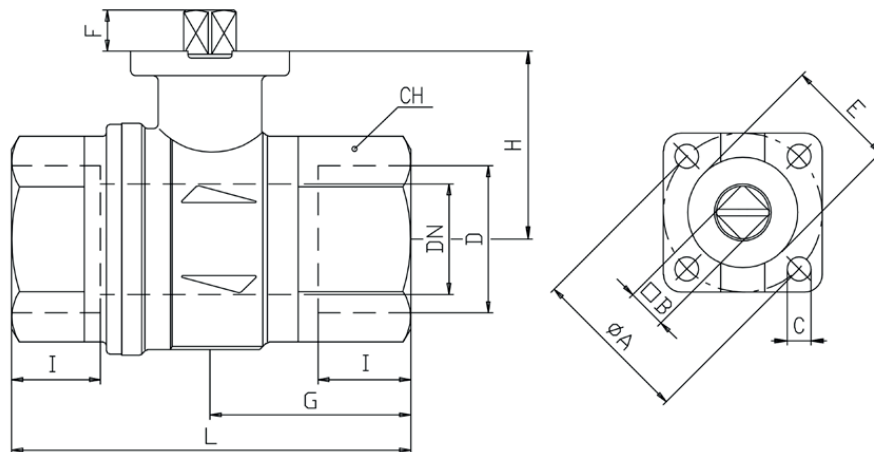
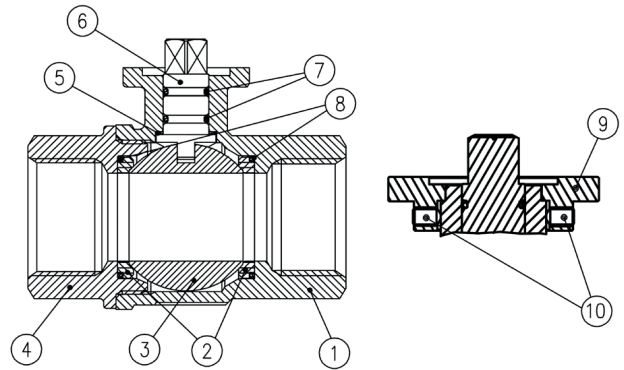

| Dimensions | | | | | | | | | | | | | |
|------------|------|-----|------|------|-----|----|----|-----|----|------|-----|------|------|
| Size | I | L | G | H | CH | ØA | B | C | E | F | ISO | Kv | Kg |
| ½" | 15.5 | 75 | 30.5 | 31 | 27 | 36 | 9 | 5.6 | 25 | 7.5 | F03 | 28 | 0.33 |
| ¾" | 18 | 80 | 37 | 38.5 | 32 | 36 | 9 | 5.6 | 25 | 8.5 | F03 | 60 | 0.48 |
| 1" | 21 | 90 | 45.5 | 42.5 | 41 | 36 | 9 | 5.6 | 25 | 8.5 | F03 | 100 | 0.8 |
| 1¼" | 23 | 110 | 52 | 55.5 | 50 | 50 | 11 | 6.6 | 35 | 10 | F05 | 155 | 1.3 |
| 1½" | 24.5 | 120 | 59 | 62 | 55 | 50 | 11 | 6.6 | 35 | 10 | F05 | 245 | 1.9 |
| 2" | 26.5 | 140 | 67.5 | 69 | 70 | 50 | 14 | 6.6 | 35 | 14.5 | F05 | 290 | 3.2 |
| 2½" | 32 | 156 | 78 | 89 | 85 | 70 | 17 | 8.5 | 55 | 18 | F07 | 516 | 4.5 |
| 3" | 35 | 177 | 88.5 | 96 | 99 | 70 | 17 | 8.5 | 55 | 18 | F07 | 770 | 6.0 |
| 4" | 41.5 | 216 | 108 | 111 | 125 | 70 | 17 | 8.5 | 55 | 18 | F07 | 1120 | 9.4 |

Further information on Page 2

Brass Ball Valve - ISO Top



LV 4502

| Torque Figures | | | | |
|----------------|------------|----------|---------|----------|
| Size | 0 - 15 Bar | | 40 Bar | |
| | To Open | To Close | To Open | To Close |
| 1/2" | 2.8 | 1.7 | 2.8 | 1.7 |
| 3/4" | 3.8 | 2.3 | 3.8 | 2.3 |
| 1" | 7.1 | 4.2 | 7.1 | 4.2 |
| 1 1/4" | 11.7 | 12.6 | 13.6 | 12.6 |
| 1 1/2" | 24.9 | 20.3 | 30.9 | 20.3 |
| 2" | 29.6 | 25.1 | 37.0 | 25.1 |
| 0 - 15 Bar | | | | |
| | To Open | To Close | To Open | To Close |
| 2 1/2" | 42.0 | 42.0 | 105.0 | 105.0 |
| 3" | 102.0 | 102.0 | 120.0 | 120.0 |
| 4" | 186.0 | 186.0 | 225.0 | 225.0 |

